

From

~~Store Front~~

To

Street Front

As our cities continue to change rapidly, it has exposed the unhealthy architectural life cycles of our turbulent retail leases and their tethered three-dimensional architectural realizations. The paradox between ephemeral tenancies and their permanent storefront and interior fit-outs is not only economically and environmentally irresponsible but leaves behind vacant shells that diminish the life on our streets. By rethinking this typology and its associated storefront, a new tenancy model is imagined, one that embraces change and creates an urban spectacle and energy in its shifting. In the repositioning from storefront to streetfront, urban street life is prioritized, promoting healthy and vibrant communities regardless of the overturn of their adjacent interior spaces. What was once a two-dimensional threshold for access becomes an avenue for equitable opportunity and a plaza for tactical urbanism.



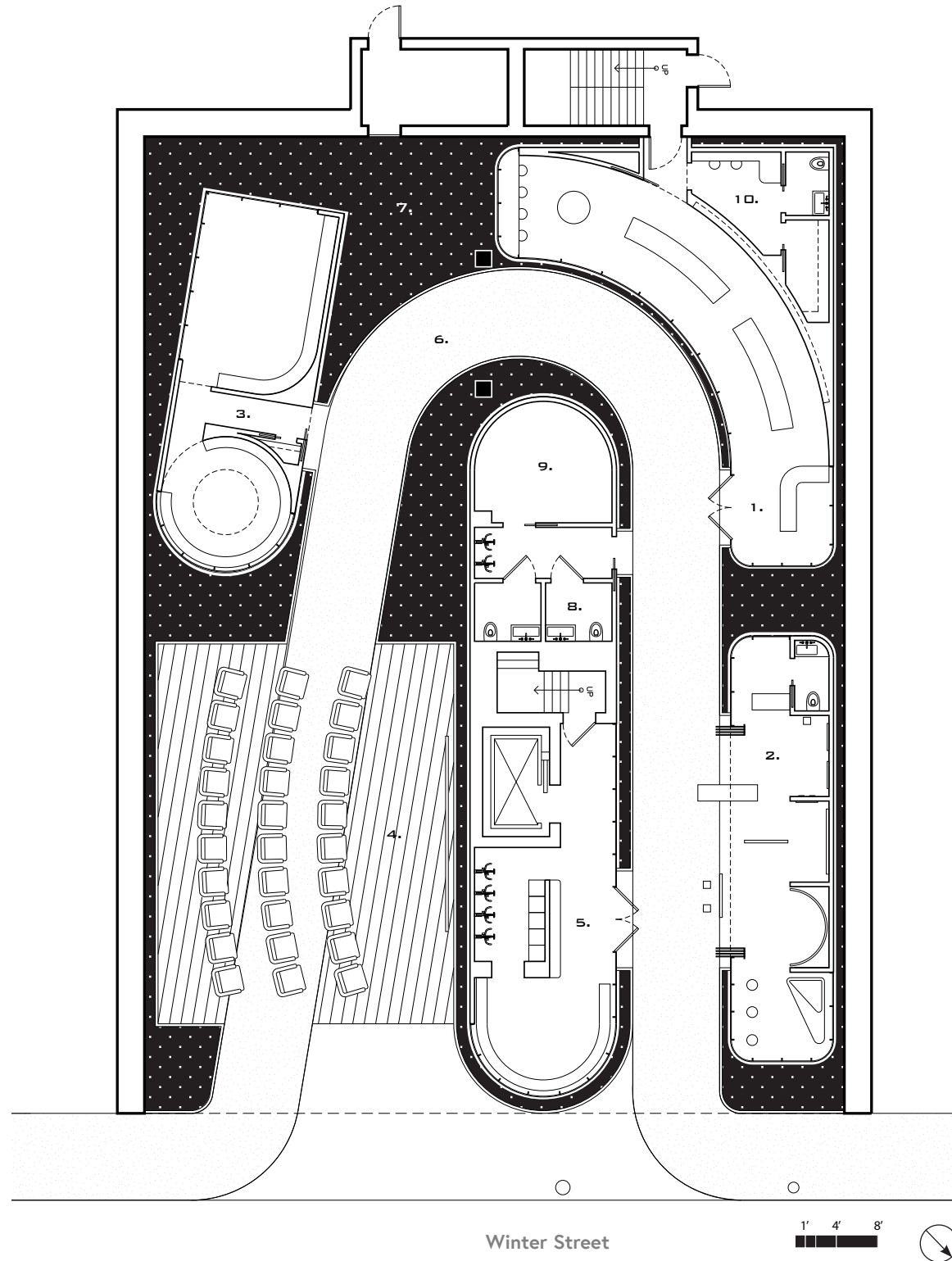

Winter Street

1' 4' 8'



- 1- Retail Space
- 2- Flexible Project Space (Art Gallery)
- 3- Healing and Meditation Center
- 4- Community Forum/Covered Patio
- 5- Residential Lobby
- 6- Boardwalk
- 7- Ecological Rain Garden
- 8- Gender Neutral Bathrooms
- 9 - Storage
- 10- Back of House

On a street scale, the sidewalk is extended and pulled into the footprint of the building, creating a covered urban boardwalk with cyclically rotating kiosks. The ideas of a storefront and vestibule are reimagined from a double-doored mechanized chamber of entry to a blurred membrane, reliant on no artificial building system, one that is neither interior nor exterior but still protected from the environment of the street. At the center of the plan, a permanent core grounds the design with the above building's residential lobby. Along the path, three additional volumes hold a formal retail space, pop-up gallery for local artists, and non-denominational healing/meditation center - all three together aiming to promote healthier, more economically diverse, and culturally represented communities, all under the footprint of "home."

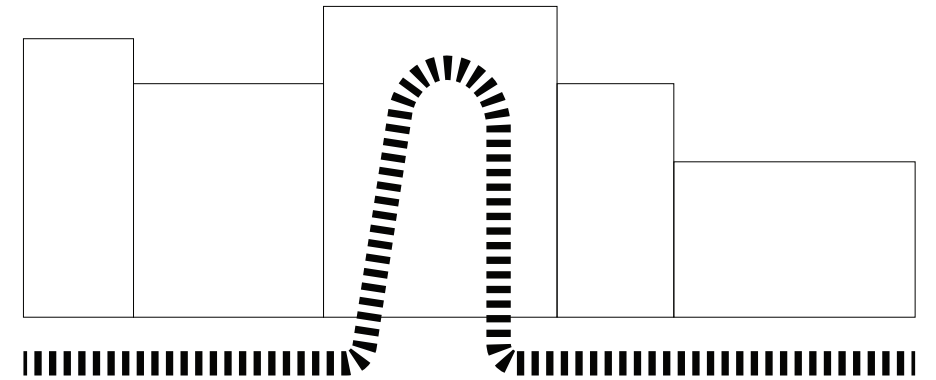

Current Proposal

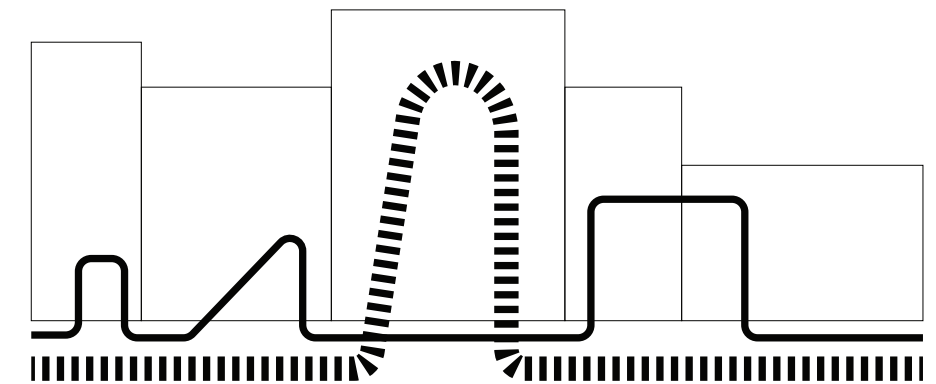

Opportunity for Neighborhood Scale Implementation



From the street, the glass of a traditional storefront is removed and instead remains a frame that is open to the public, putting the various life inside on display. Light covers extend from within and wrap up the facade to create marquis-style signage bands for the promotion of rotational internal identity. The rotation of these elements and upkeep are repositioned from remedial maintenance to spectacles and reflections of dynamic urban life.

Within the footprint of the building, the boardwalk winds slightly elevated above a sunken reflecting pool, filled with ecological life supported by green-friendly downlighting above. This porosity, both between the interior/interior and the boardwalk/ecological pool below, creates an architectural model that is adaptive in an environment that is highly susceptible to ground-floor flooding as impending threats of climate change increase.

